

ZONE	REV	REVISION DESCRIPTION	ECN NO.	DATE
D		PERFORMANCE CHARACTERISTICS: ADD 30 AND 40 AMP TO VOLTAGE DROP TEMPERATURES WERE: +23°C (+73°F) +70°C (+158°F) 55°C (+131°F) MIN. ULT. TRIP WAS: 110% RATING 105% RATING 110% RATING MAX. ULT. TRIP WAS: 145% RATING 145% RATING 165% RATING : PD	ECN0051577	19-MAY-2009

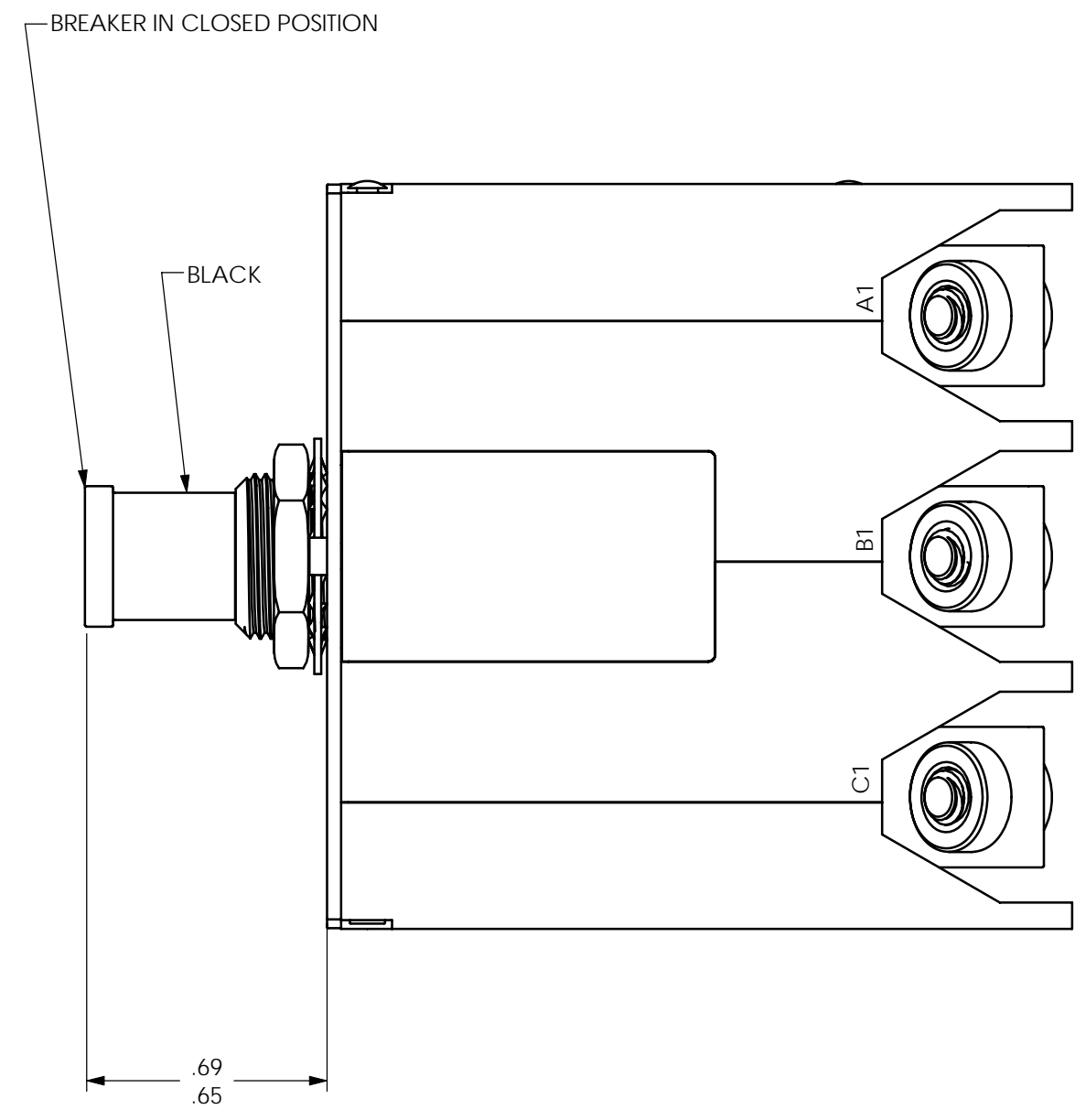

- NOTES:
- EPOXY SURFACES ARE NON-DIMENSIONED. ENVELOPE DIMENSIONS DO NOT APPLY TO THESE EPOXY SURFACES.
  - TERMINAL AND MOUNTING HARDWARE MAY BE PACKAGED RATHER THAN INSTALLED.
  - COUNTRY OF ORIGIN IS SHOWN FOR ILLUSTRATION PURPOSES ONLY. COUNTRY OF ORIGIN WILL BE IDENTIFIED AS REQUIRED.
  - DATE CODE PER 10588-285.
  - MARK IN APPROXIMATE POSITION SHOWN IN BLACK INK PER 12506-70.
  - VOLUME: 2.4859 CUBIC INCHES

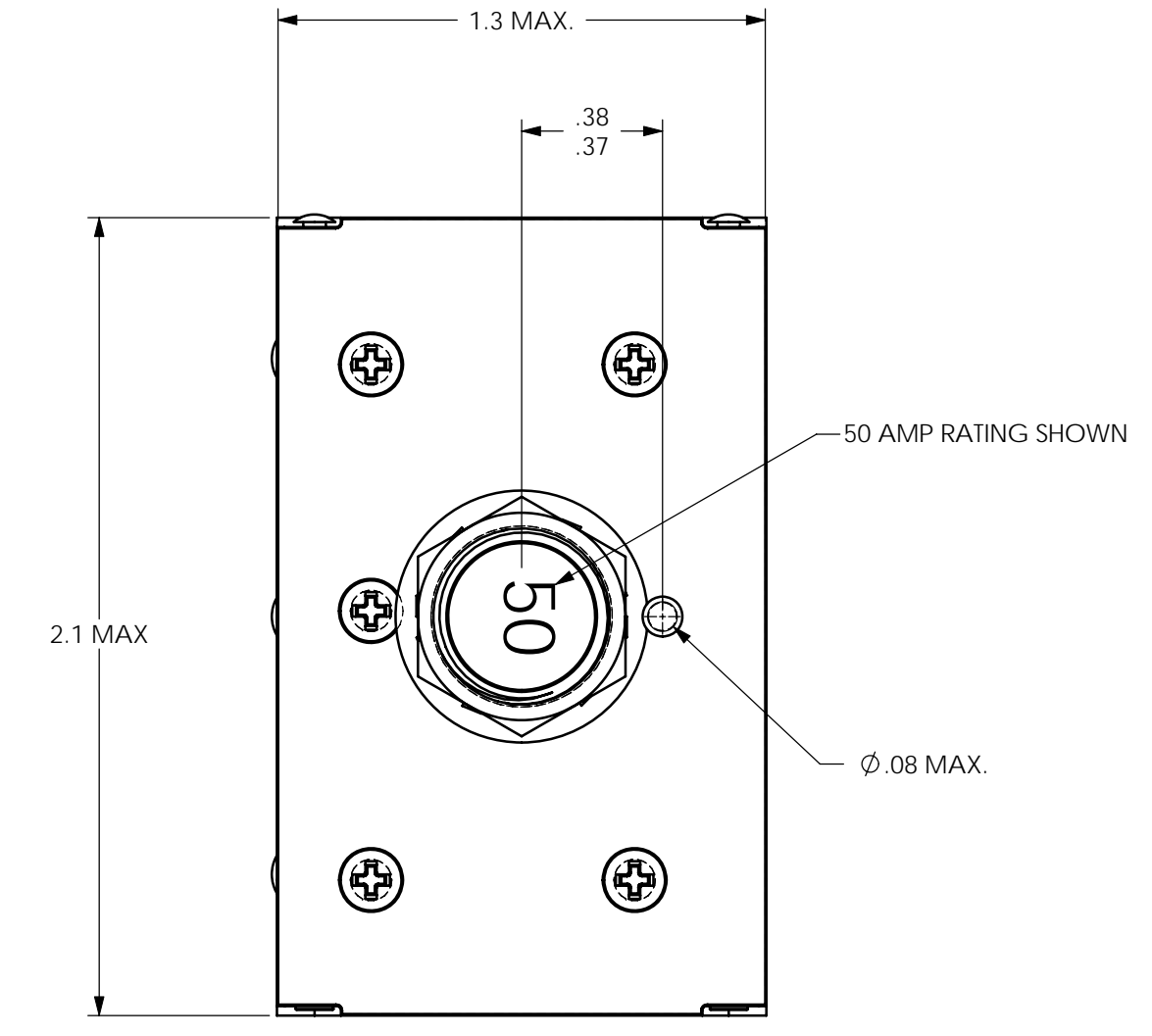
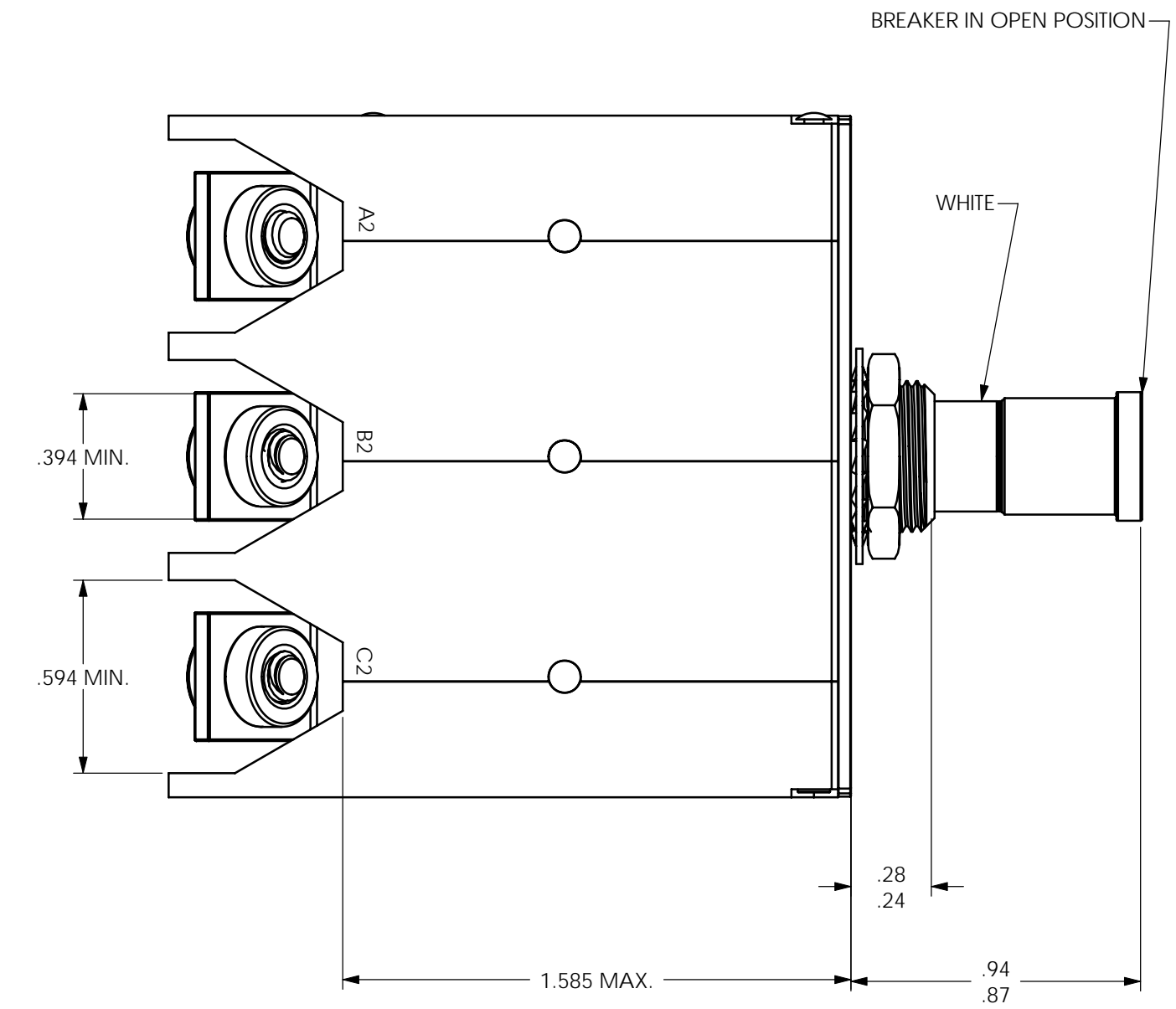
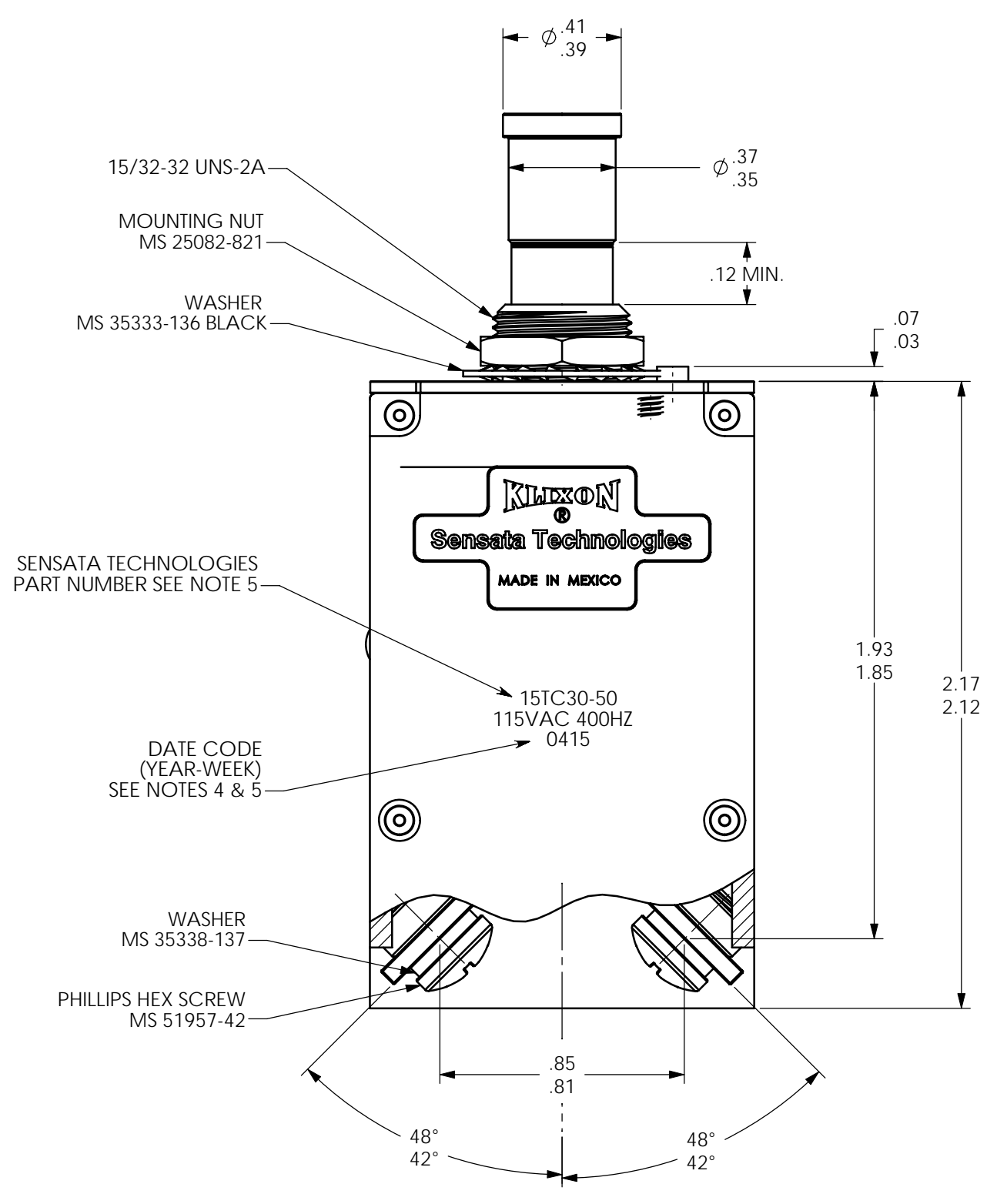

### PERFORMANCE CHARACTERISTICS

VIBRATION	.....	CURVE 'J' OF EUROCAE ED-14B, 3 G'S, 2000 HZ
MECHANICAL SHOCK	.....	50 G'S
CORROSION	.....	SALT SPRAY 48 HOURS
HUMIDITY	.....	48 HOURS

ENDURANCE:	115 VAC MECHANICAL	400 HZ INDUCTIVE NO LOAD	2500 CYCLES	5000 CYCLES	
SINGLE * OR THREE PHASE CALIBRATION:	20 AMP THRU 50 AMP				
	MIN. ULT. TRIP	MAX. ULT. TRIP	200% (SEC.)	500% (SEC.)	1000% (SEC.)
+25°C (+77°F)	105% RATING	138% RATING	10-70	0.15-5.2	0.05-1.3
+71°C (+160°F)	70% RATING	110% RATING			
-54°C (-65°F)	130% RATING	160% RATING			
SHORT CIRCUIT RESISTANCE:	20 AMP THRU 50 AMP	115 VAC, 400 HZ	1500 AMPS RMS		
OPERATIONAL FORCES:	PULL OUT ..... 12 LBS. MAX.				
	RESET ..... 16 LBS. MAX.				
OPERATING ALTITUDE:	15,000 M (49,200 FT.)				
WEIGHT INCLUDING CONNECTION HARDWARE:	0.350 LBS. MAX.				
VOLTAGE DROP:	20 AMP	.....	0.300 VOLTS MAX.		
	25 AMP	.....	0.300 VOLTS MAX.		
	30 AMP	.....	0.300 VOLTS MAX.		
	35 AMP	.....	0.300 VOLTS MAX.		
	40 AMP	.....	0.300 VOLTS MAX.		
	50 AMP	.....	0.300 VOLTS MAX.		

\* SINGLE PHASE MAXIMUM ULTIMATE TRIP VALUES APPLY WITH OTHER TWO PHASES CARRYING 100% OF RATED CURRENT.

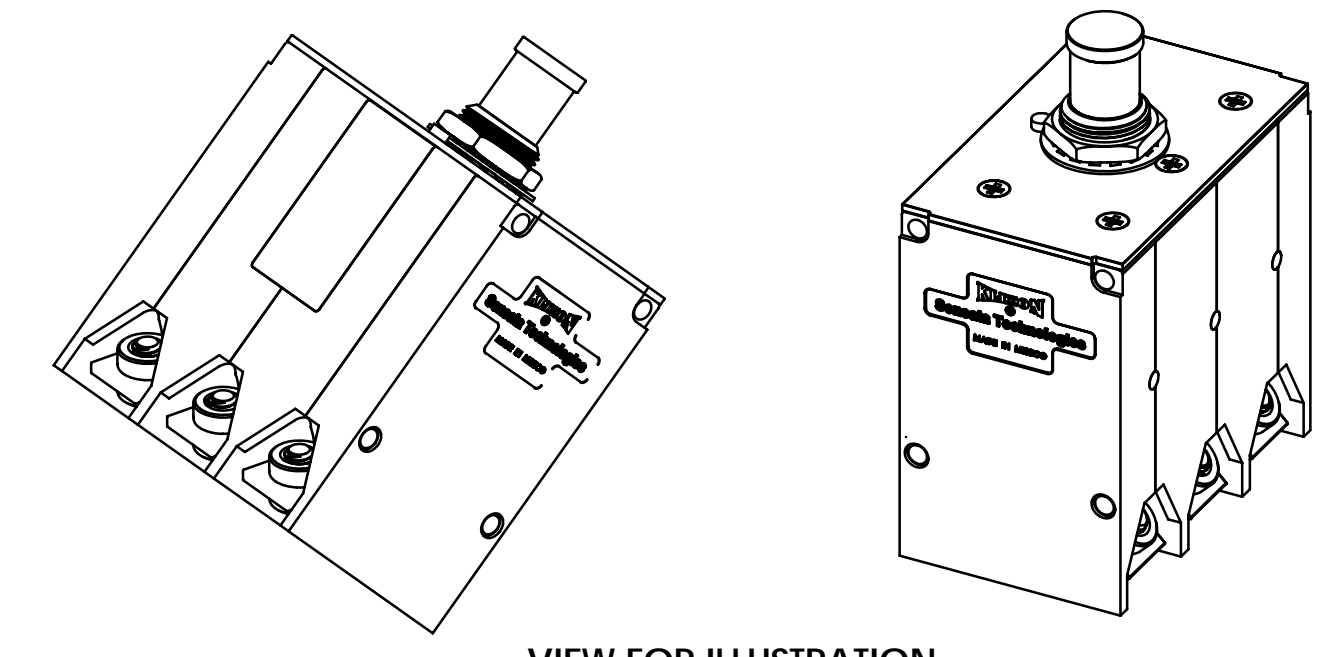
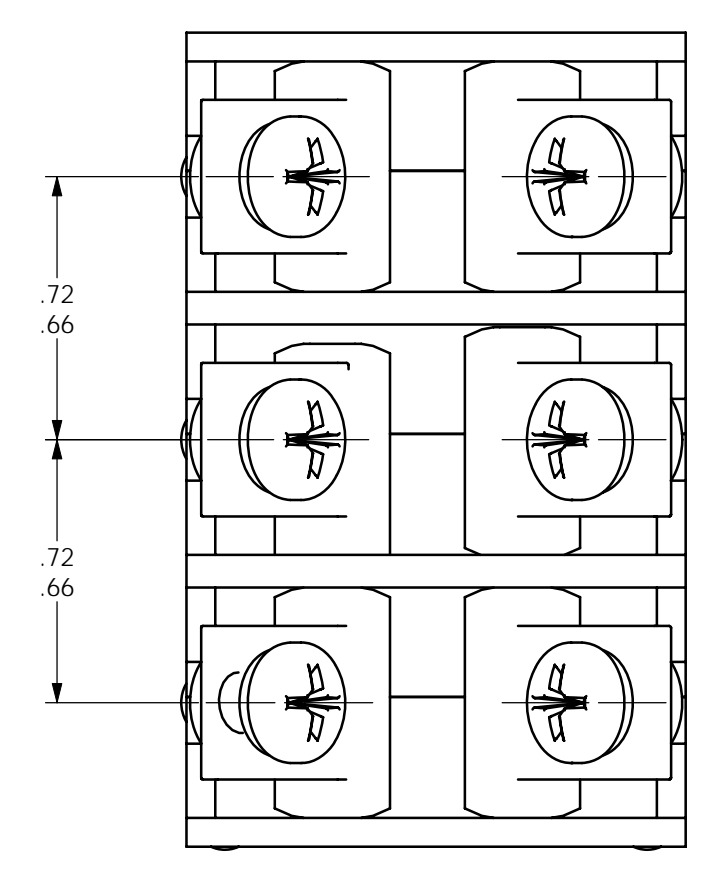

FOR REFERENCE ONLY. CHECK LATEST REVISION BEFORE USE. PARIS MADE TO THIS PRINT MUST CONFORM TO E9898 REV. E			
DRAWN G. LAPATI DATE 11-OCT-2006	NEITHER THIS PRINT NOR THE INFORMATION CONTAINED HEREON IS TO BE USED AGAINST THE INTERESTS OF SENSATA TECHNOLOGIES OR AGAINST THE INTERESTS OF ANY OF ITS AFFILIATED COMPANIES OR WHOLLY OWNED SUBSIDIARIES.		
ENGINEER B. BENTLEY DATE 11-OCT-2006	UNLESS OTHERWISE SPECIFIED DIMENSIONS ARE IN INCHES TOLERANCES		
APPROVED W. BLENKHORN DATE 11-OCT-2006	DECIMALS XX ±.1	ANGLES XX° ±1°	TITLES 15TC CIRCUIT BREAKER PUSH PULL, TRIP FREE ENVELOPE DRAWING
APPROVED P. BERG DATE 11-OCT-2006	THIRD ANGLE PROJECTION	SIZE D	DWG NO. 15TC30
DO NOT SCALE DRAWING		SCALE 1:1	REV D
DEVICE: 15TC30		PROJECT: EX3636	SHEET 1 OF 1